

CLATSKANIE-QUINCY C.P.A.C.

WETLAND AND HYDRIC SOILS

Columbia County

Prepared by:  beak consultants incorporated

DATE: 6/26/95 PROJ. NO. 73824

CLAT3A.dwg

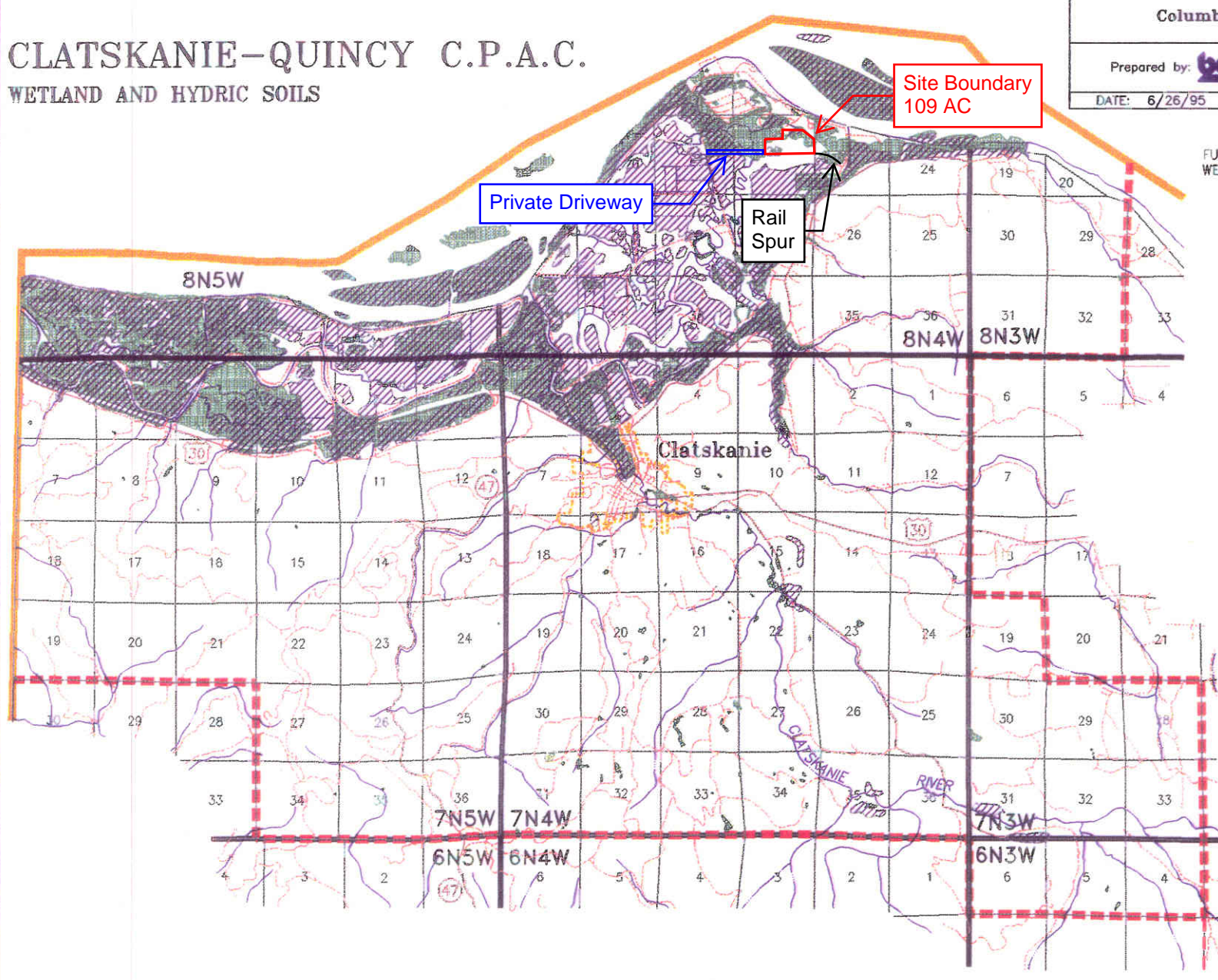

FUNDS FOR THIS MAP
WERE PROVIDED BY LCDC.



LEGEND

-  HYDRIC SOILS
-  WETLANDS