

PERMIT AND HOLD HARMLESS AGREEMENT
for use of Columbia County Facilities

THIS AGREEMENT is by and between **Weyerhaeuser Company**, hereinafter referred to as "Permittee", and **COLUMBIA COUNTY**, a political subdivision of the State of Oregon, hereinafter referred to as "County", for the use of a County Facility, as follows:

Name of Facility: **Crown Z Trail**

Address of Facility: **Sections 14 and 15 T4NR3W**

Name of Event: **Tailhold of timber over the Crown Z Trail**

Description of the Event (areas where the event will take place and how those areas will be used):

Permittee is granted permission to tailhold timber over the parts of the Crown Z Trail shown as Tailhold area on the attached Exhibit A.

Dates of the Event: **October 1, 2025 through December 31, 2025, however Permittee shall not interfere with the public's use of the trail from 6:00 pm on Friday's through 12:01 am on Mondays.**

In consideration of the permission given by County for Permittee to use the County Facility for the above-described Event, Permittee agrees to release, indemnify, defend and hold harmless the County, its officers, agents and employees, successors and assigns against all liability, loss, and costs arising from actions, suits, claims, or demands, except when due to the County's sole negligence, arising in any manner out of the use of such facilities by Permittee, its officers, agents, employees, members or invited guests.

In addition, Permittee agrees to provide a certificate of insurance in an amount of not less than \$2,000,000 per occurrence to protect County, its officers, agents, and employees. Permittee shall provide County a certificate or certificates of insurance in the amounts described above which names Columbia County, its officers, agents and employees as additional insureds at least 30 days in advance of the event. Such certificate or certificates shall be accompanied by an additional insured endorsement containing the same language. Permittee shall notify County immediately upon notification to Permittee that any insurance coverage required by this paragraph will be canceled, not renewed or modified in any material way.

In addition, Permittee agrees, at its own expense to:

1. Place all related cabling at a sufficient height that it does not block hikers on the trail; and
2. Place flaggers on the trail during operations to stop hikers while timber is being carried overhead; and

C131-2025

3. At least 14 days prior to operations post signs on both ends of the tailhold area warning of the upcoming operations; and
4. Upon commencement of operations, post signs on both ends of the tailhold area warning hikers of the operations taking place; and
5. Not remove any timber from the County easement area without written permission from the County's Director of General Services and to pay the County the fair market value for any timber removed; and
6. Remove all equipment, personal property, trash, dirt or other debris from the County easement at the conclusion of operation; and
7. Repair any damage to the trail at the conclusion of operations.

Permittee acknowledges that the County may, at its sole discretion, revoke this permit and/or require removal of equipment or other personal property from County property. This permit does not entitle the permittee to exclusive use of County property, nor does it entitle permittee to sublet or charge a fee for use of County property.

PERMITTEE: Weyerhaeuser Company
PO Box 667
3539 Industrial Way, Suite A
Longview, WA. 98632
360-355-6251

BOARD OF COUNTY COMMISSIONERS
FOR COLUMBIA COUNTY, OREGON

By: 
(Signature of Authorized Representative)

By: _____
Chair

Name: Jeremy Sepp
(Printed Name of Authorized Rep.)

Date: _____, 2025

Date: 9/16/2025, 2025

ArcGIS Web Map

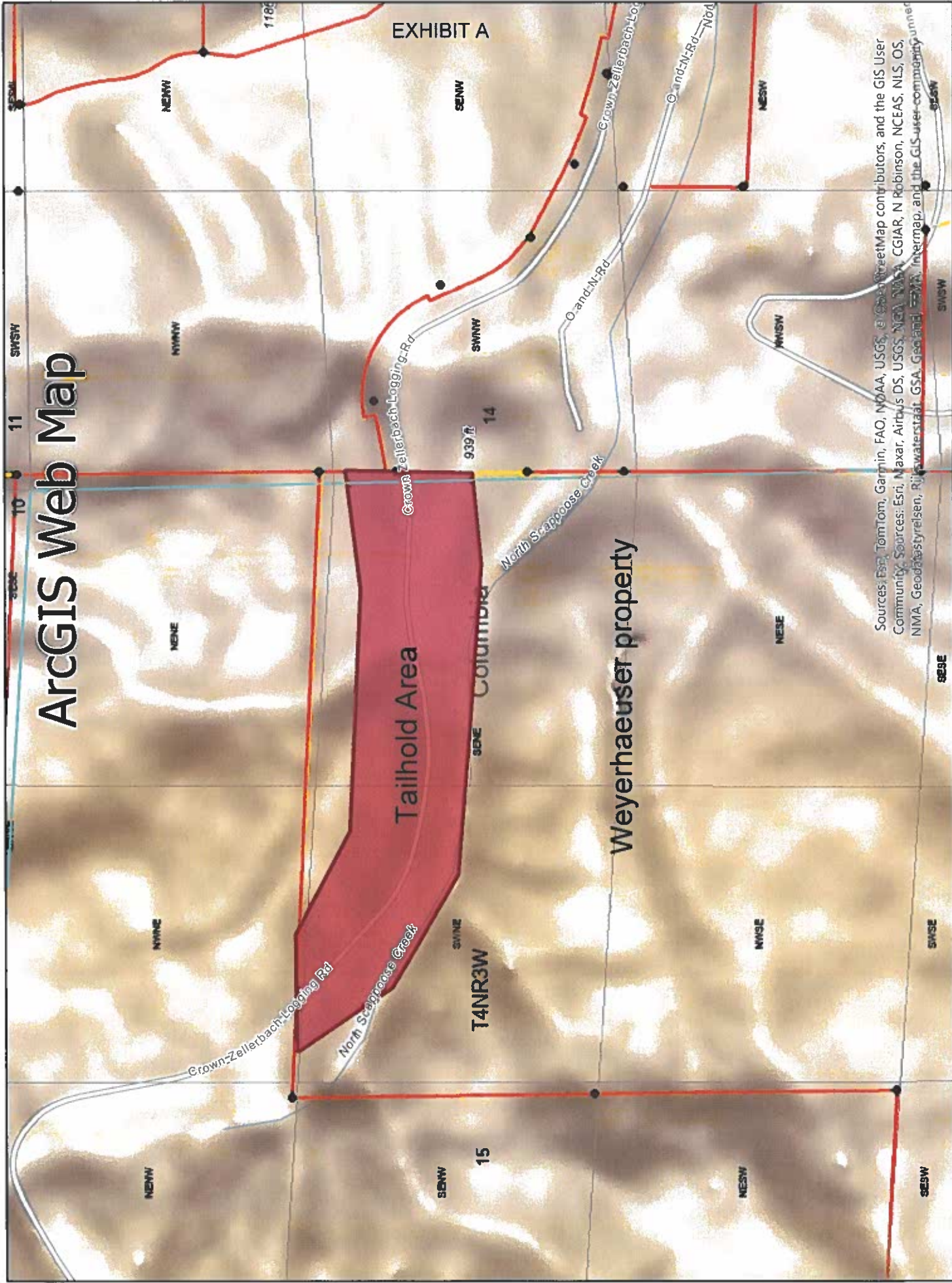

Sources: Esri, TomTom, Garmin, FAO, NOAA, USGS, OpenStreetMap contributors, and the GIS User Community. Sources: Esri, Maxar, Airbus DS, USGS, NOAA, NASA, CGIAR, N Robinson, NCEAS, NLS, OS, NMA, Geodatasystrelen, Rijkswaterstaat, GSA, Geo and FEMA, Intermap, and the GIS user community.

1:9,028

0 0.07 0.15 0.3 mi

Source: Esri, European Commission, European Space Agency, Amazon