

BID 4

Tax lot; 12279

Map ID No.; 4N1W05-CC-02500

Situs Address; Greenwood Acres, St. Helens (Columbia Blvd)

Zoned; SH: AR Residential Site / 1.35 acres

2021 Assessment \$50,070.00

Deed to County in 2020 by Deed No. 2020-010428 (list no. 18-021)

Minimum Bid price \$77,160.00 (15% \$ 11,574.00)

OFFICIAL RECORD

OF DESCRIPTIONS

TAX ACCOUNT NO: 12279

ACCOUNT: 4N1W05-CC-02500

REAL PROPERTIES

18-021

A tract of land in the Southwest quarter of Section 05, Township 4 North, Range 1 West, Willamette Meridian, Columbia County, Oregon, being more particularly described as follows:
Tract A of the Bruce Hall Subdivision, City of St. Helens, Columbia County, Oregon.

COLUMBIA County Assessor's Summary Report

Real Property Assessment Report

FOR ASSESSMENT YEAR 2021

February 14, 2022 12:27:19 pm

Account # 12279
Map # 4N1W05-CC-02500
Code - Tax # 0201-12279
Legal Descr GREENWOOD ACRES
 Lot - PT TR 18
Mailing Name COLUMBIA COUNTY
Agent
In Care Of TAX COLLECTOR
Mailing Address 230 STRAND ST
 ST HELENS, OR 97051

Tax Status NONASSESSABLE
Acct Status ACTIVE
Subtype NORMAL

Deed Reference # 2020-10428
Sales Date/Price 10-07-2020 / \$0.00
Appraiser WENDY VITALE

Prop Class 100 **MA** **SA** **NH** **Unit**
RMV Class 100 01 00 000 55596-1

Situs Address(s)		Situs City			
Code Area	RMV	MAV	Value Summary AV	RMV Exception	CPR %
0201	Land 77,160			Land 0	
	Impr. 0			Impr. 0	
Code Area Total	77,160	0	0	0	
Grand Total	77,160	0	0	0	

Code Area	ID#	RFPD	Ex	Plan Zone	Value Source	Land Breakdown			LUC	Trended RMV
						TD%	LS	Size		
0201	1	<input checked="" type="checkbox"/>	1	SH:AR	Residential Site	108	S	13,939.00	002	37,220
0201	2	<input checked="" type="checkbox"/>	1	SH:AR	Residential Site	108	S	44,867.00	002	39,940
Grand Total								58,806.00		77,160

Code Area	Yr ID#	Stat Built	Class	Description	Improvement Breakdown	TD%	Total Sq. Ft.	Ex% MS Acct #	Trended RMV
Grand Total									0

Code Area	Type	Exemptions/Special Assessments/Potential Liability
NOTATION(S): <input checked="" type="checkbox"/> REVIEW FOR USE CONSISTENT WITH NEW ZONING		

Appr Maint: 2021 - TAX STATUS CHANGE TO NON-ASSESSABLE
Comments: 2020-010428 deed of foreclosure, made nonassessable. NS
 2017 RA WV
 Fragment 2, 44,867 SF (1.03 Ac) made unbuildable because of low wet topo.

Columbia County Web Map

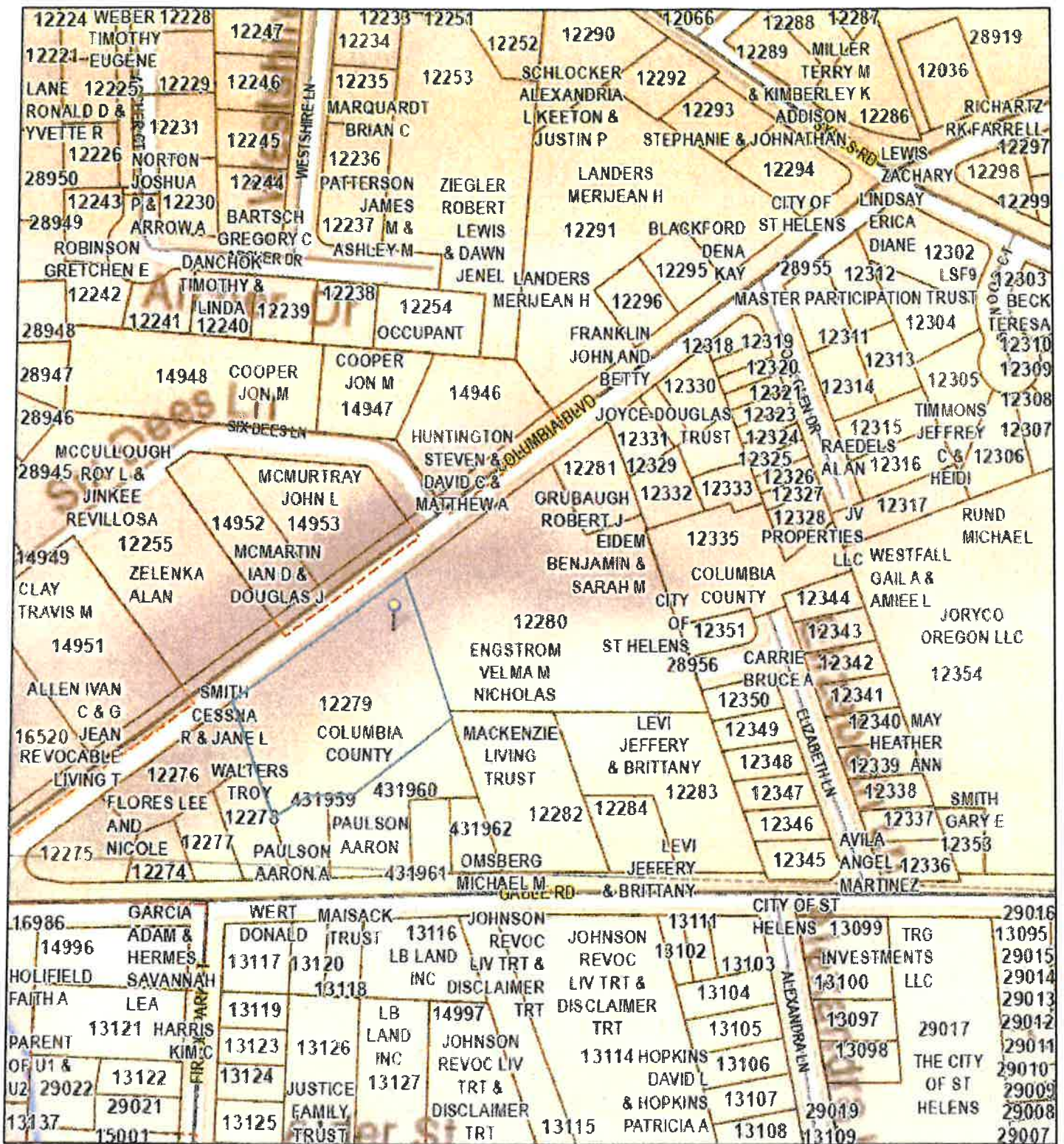

February 14, 2022

1:2,400

