

BID 2

Tax lot 19503

Map ID No. 7N2W17-BD-03600

Situs Address; Grace Ave. Rainier

Zoned; CO: MF/ 6,230 sq. ft. (.14acres)

2021 Assessment \$44,570.00 RMV

2021 Assessment 0 improvements

Deeded to the County in 2020 by Deed No. 2020-010428(list no. 18-081)

Minimum Bid price \$44,570 (15% \$6,685.50)

OFFICIAL RECORD

OF DESCRIPTIONS

TAX ACCOUNT NO: 19503

ACCOUNT: 7N2W17-BD-03600

REAL PROPERTIES

18-081

A tract of land in the Northwest quarter of Section 17, Township 7 North, Range 2 West, Willamette Meridian, Columbia County, Oregon, being more particularly described as follows: Lot 4, Block 38, Unit C, West Rainier, Columbia County, Oregon.

COLUMBIA County Assessor's Summary Report
Real Property Assessment Report
 FOR ASSESSMENT YEAR 2021

February 14, 2022 12:15:57 pm

Account # 19503
Map # 7N2W17-BD-03600
Code - Tax # 0305-19503
Legal Descr WEST RAINIER UNIT C
 Block - 38 Lot - 4
Mailing Name COLUMBIA COUNTY
Agent
In Care Of TAX COLLECTOR
Mailing Address 230 STRAND ST
 ST HELENS, OR 97051

Tax Status NONASSESSABLE
Acct Status ACTIVE
Subtype NORMAL
Deed Reference # 2020-10428
Sales Date/Price 10-07-2020 / \$0.00
Appraiser MELINDA GARTMAN

Prop Class 400 **MA** **SA** **NH** **Unit**
RMV Class 400 04 41 000 55599-1

Situs Address(s) **Situs City**

Code Area	RMV	MAV	Value Summary		RMV Exception	CPR %
			AV			
0305 Land	44,570				Land	0
Impr.	0				Impr.	0
Code Area Total	44,570	0	0	0		0
Grand Total	44,570	0	0	0		0

Code Area	ID#	RFPD	Ex	Plan Zone	Value Source	Land Breakdown			LUC	Trended RMV	
						TD%	LS	Size			
0305	1	<input checked="" type="checkbox"/>	1	CO:MF R	Market	114	S	6,230.00	WS	003	44,570
Grand Total								6,230.00			44,570

Code Area	ID#	Yr Built	Stat Class	Description	Improvement Breakdown			Total Sq. Ft.	Ex% MS Acct #	Trended RMV
					TD%					
Grand Total								0		0

Appr Maint: 2021 - TAX STATUS CHANGE TO NON-ASSESSABLE
Comments: 2020-010428 deed of foreclosure, made nonassessable. NS
 2019: RA - MG
 2011 previous appraisal assumed non buildable, no data at this time to verify that, valued as buildable. NS

Columbia County Web Map

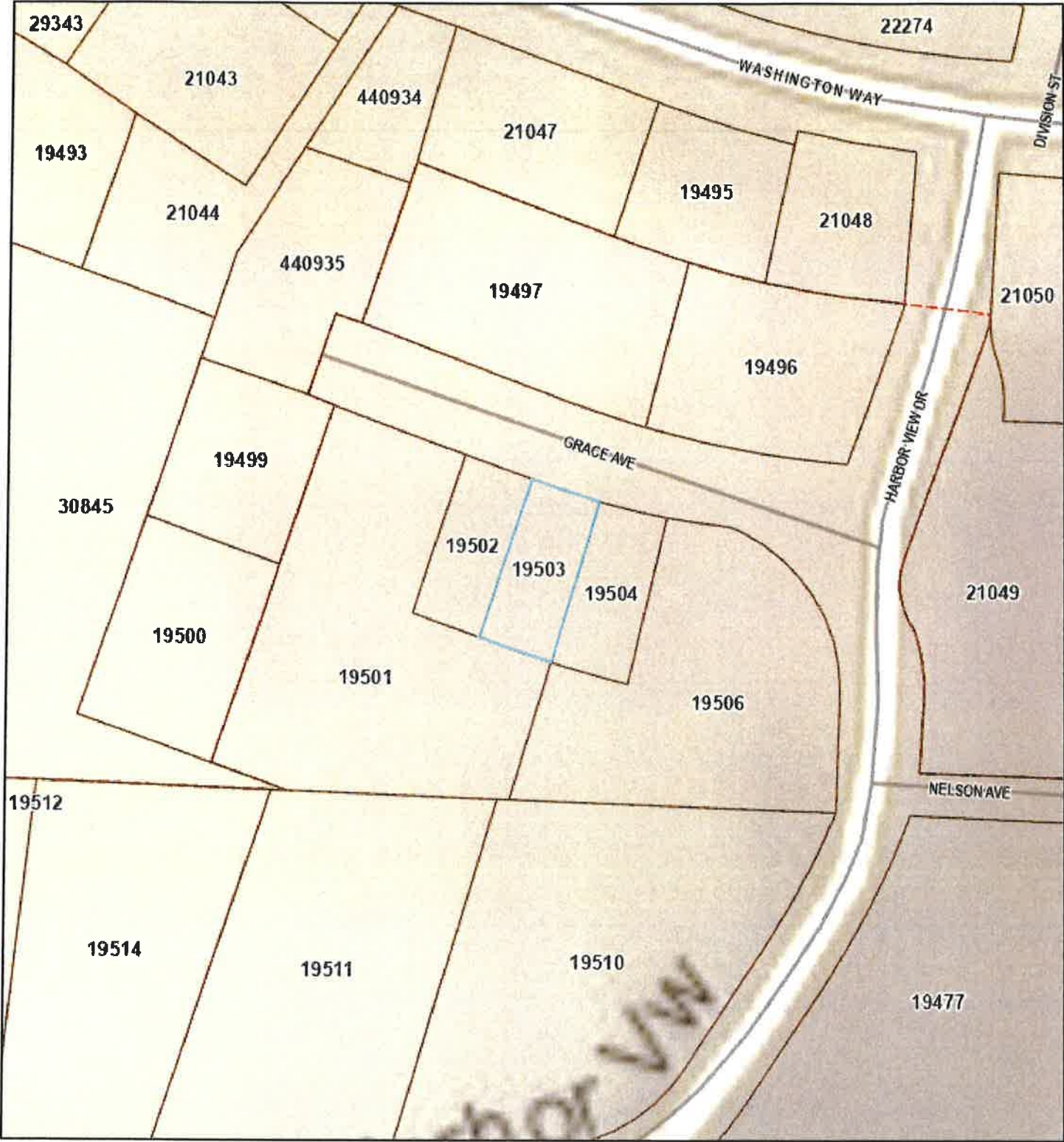

September 10, 2021

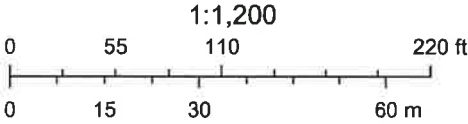

National Geographic, Esri, Garmin, HERE, UNEP-WCMC, USGS, NASA, ESA, METI, NRCAN, GEBCO, NOAA, increment P Corp.